

Waterhouse Business Centre

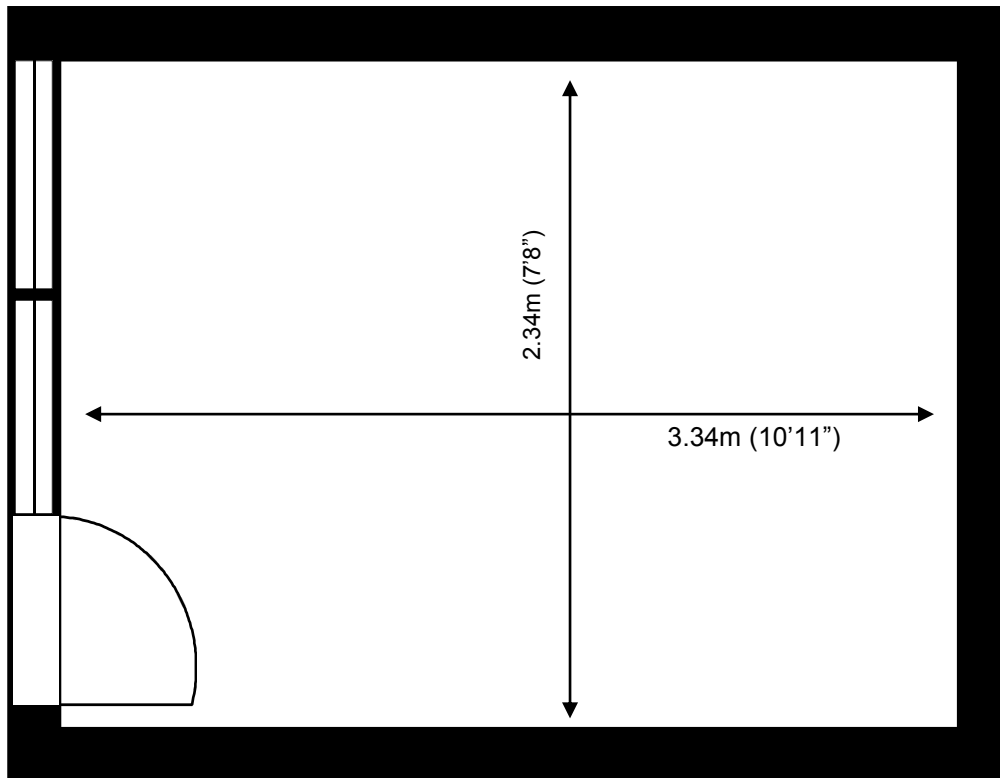

Ground Floor - Unit 610

8.1 sq m (87 sq ft)*



Waterhouse Business Centre

Cromar Way
Chelmsford
Essex CM1 2QE
01245 392000

*Approximate Measurements

Not to scale

Space for growing businesses

www.capitalspace.co.uk

Waterhouse Business Centre

Ground Floor - Unit 610

8.1 sq m (87 sq ft)*

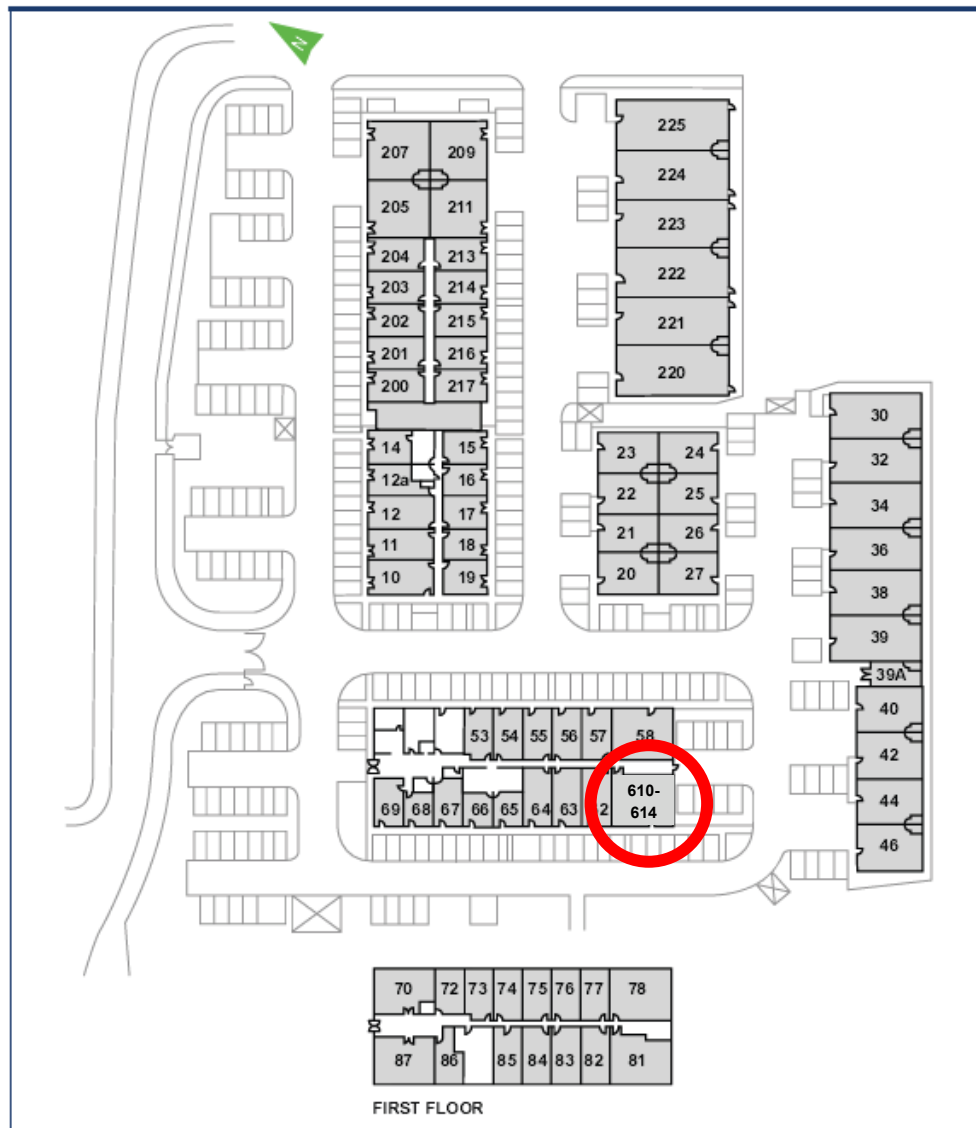

Additional Information

Includes air conditioning

Waterhouse Business Centre

Cromar Way
Chelmsford
Essex CM1 2QE

01245 392000

*Approximate Measurements

Not to scale