

Waterhouse Business Centre

Ground Floor - Unit 612

15.1 sq m (163 sq ft)*

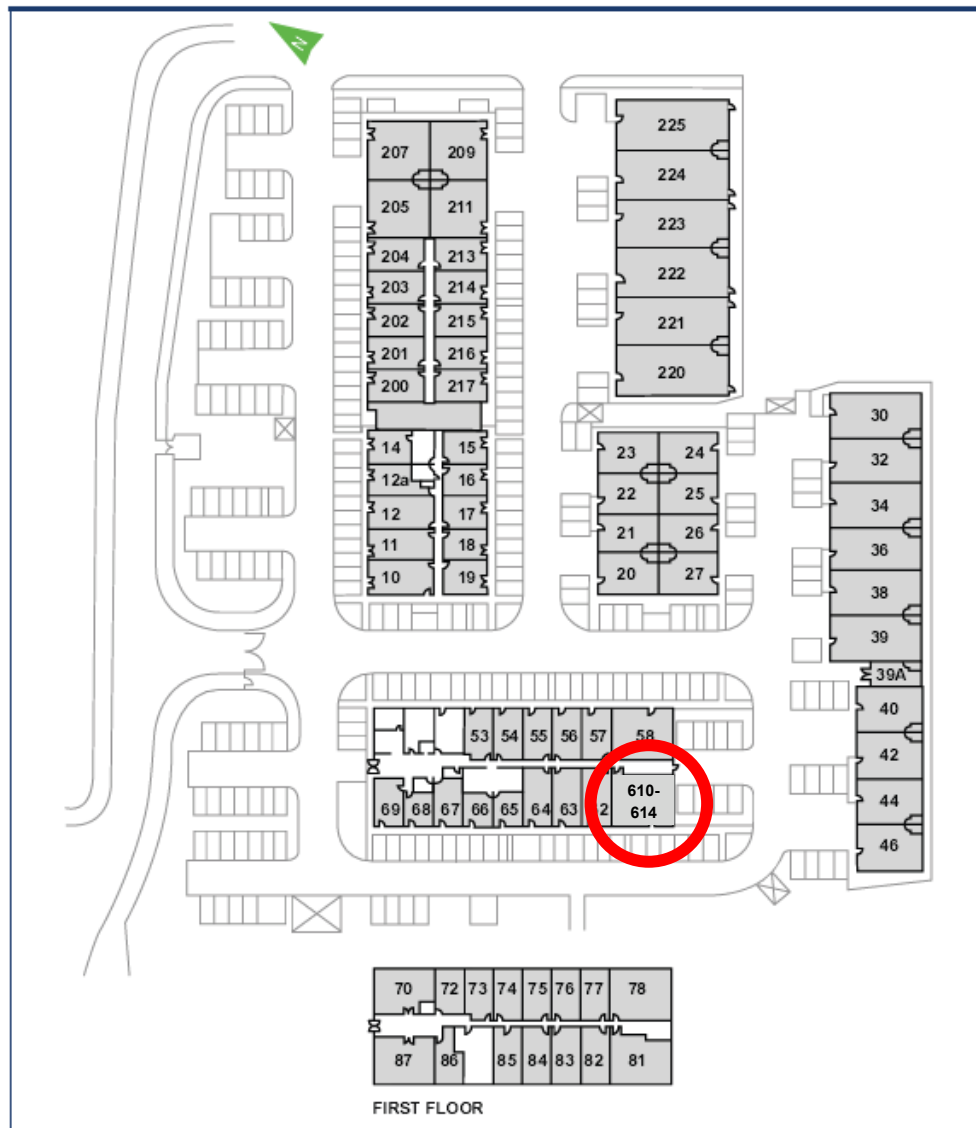

Additional Information

Unit 612 has an external door to the car park

We are happy to provide further details and answer any questions.
Please contact our Centre Manager on 01245 392000.

Waterhouse Business Centre

Cromar Way
Chelmsford
Essex CM1 2QE

01245 392000

*Approximate Measurements

Not to scale