

Capital Business Centre

Ground Floor—Unit 36

70 m (753 sq ft)*

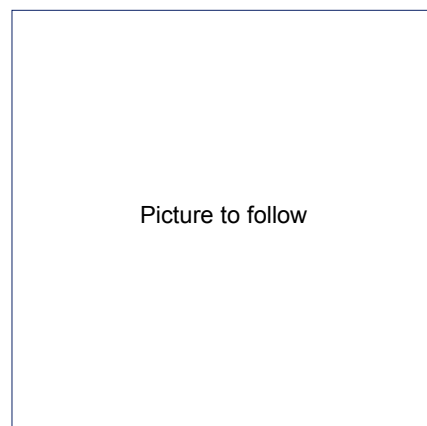
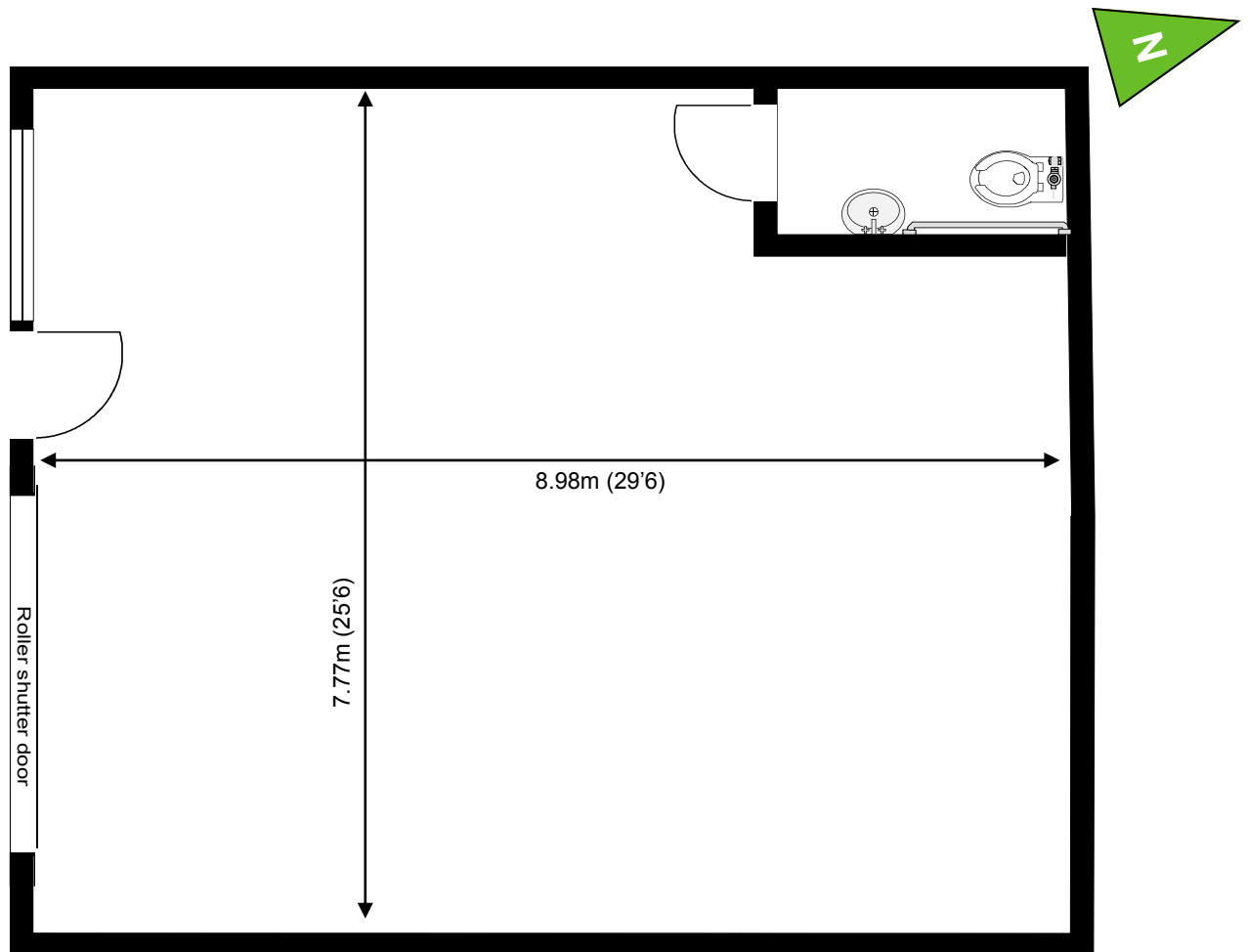

Capital Business Centre
22 Carlton Road
South Croydon
Surrey CR2 0BS

*Approximate Measurements

Not to scale

Space for growing businesses

www.capitalspace.co.uk

Capital Business Centre

Ground Floor—Unit 36
70 m (753 sq ft)*

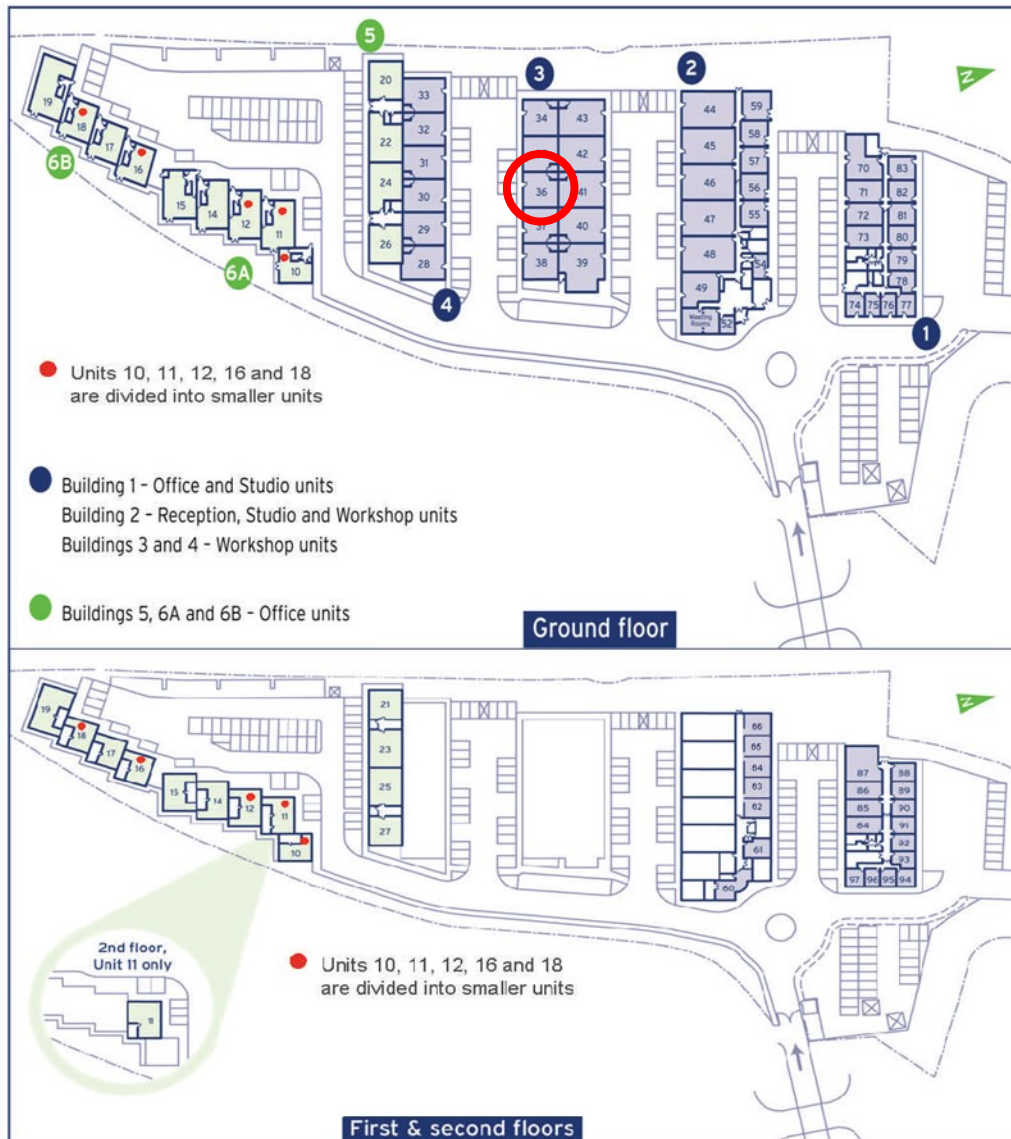

Additional Information

Own entrance, own toilet. Roller shutter door.

We are happy to provide further details and answer any questions.
Please contact our Centre Manager on 020 8916 2000.