

Waterhouse Business Centre

Ground Floor - Unit 53
38.5 sq m (414 sq ft)*

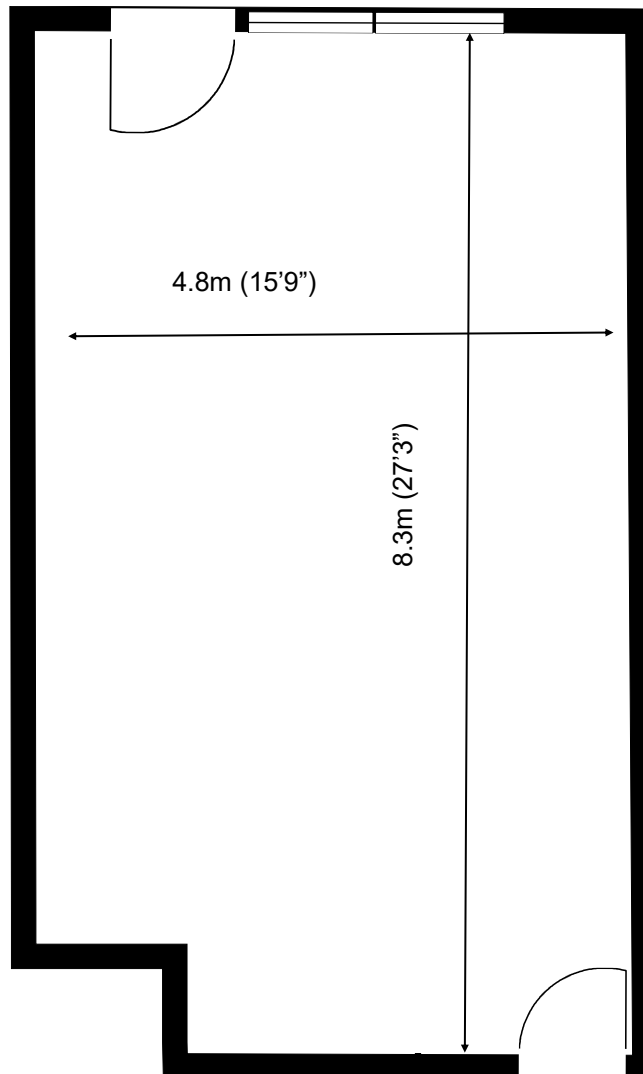

Waterhouse Business Centre
Cromar Way
Chelmsford
Essex CM1 2QE
01245 392000

*Approximate Measurements
Not to scale

Space for growing businesses

www.capitalspace.co.uk

Waterhouse Business Centre

Ground Floor - Unit 53
38.5 sq m (414 sq ft)*



Additional Information

Glazed internal office 1.9m x 3.6m.

We are happy to provide further details and answer any questions.
Please contact our Centre Manager on 01245 392000.

Waterhouse Business Centre
Cromar Way
Chelmsford
Essex CM1 2QE
01245 392000

*Approximate Measurements
Not to scale